

Current Framing Practice

This literature challenges current framing practices and proposes an alternative, as illustrated in below image. The alternative method improves thermal efficiency and minimise joint imperfections commonly resulting from linings being fixed to multiple timber framingn members which move independently with moisture changes or when the building is subjected to wind or earthquake forces.

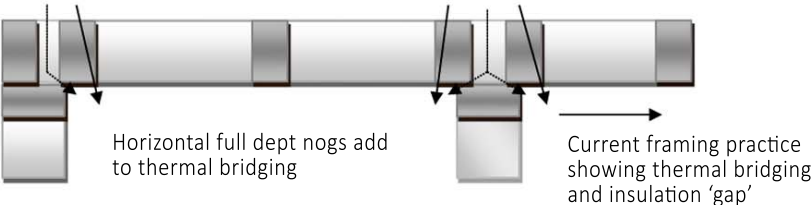

Proposed Framing Practice

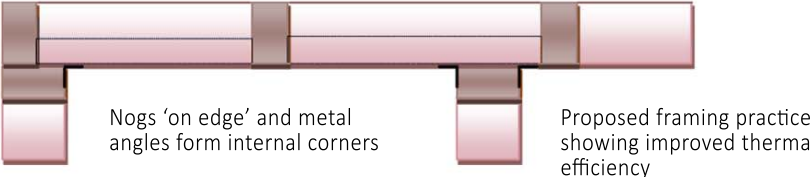

Wall Junction Details

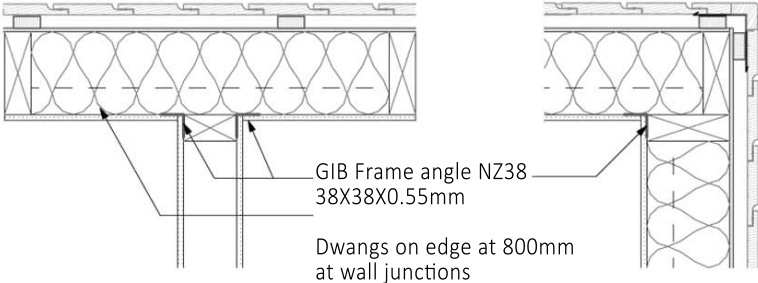

GIB Rondo Ceiling Battens & Wall to Ceiling Details

